



## Installation Instructions

### TABS® Mobility Monitor

25000 series



#### **▲ WARNING**

Before installing this system, please read and follow these instructions carefully. Failure to do so could result in injury or death to a person in your care. No device is a substitute for proper nursing care.



ETL Listed 3064149\*  
Conforms to UL1069\*  
Certified to CSA STD C22.2 NO.205\*

\* TABS® Professional (Model 25022) Only

**STANLEY**

**Senior Technologies™**

0163-044-Q

# Contact us

Thank you for purchasing your TABS® system. If you have questions about your TABS® monitoring system or would like to speak to TABS® Customer Service, call:

**TABS® Mobility Monitors: In the U.S. call 800-824-2996**

FCC ID: HCQ 3B6UMXF Canada: 2309 101 597

This device complies with Part 15 of the FCC rules. Operation is subject to the following two conditions: 1) this device may not cause harmful interference, and 2) this device must accept any interference received, including interference that may cause undesired operation.

Changes or modifications not expressly approved by the party responsible for FCC compliance could void the user's authority to operate the equipment.

For Canadian customers: "This digital apparatus does not exceed the class A limit for radio noise emissions from digital apparatus as set out in the interference causing equipment standard entitled "Digital Apparatus" "ICES-003 of Industry Canada".

All content herein is the property of The Stanley Works, its Affiliates, or their content suppliers and is protected by United States and international copyright laws. The compilation of all content is likewise the exclusive property of The Stanley Works (or the Affiliate identified in any copyright notice) and is protected by United States and international copyright laws.

The trademarks, service marks and logos (the "Trademarks") used and displayed in this publication are registered and unregistered Trademarks of The Stanley Works, its Affiliates and others. Nothing herein should be construed as granting, by implication, estoppel or otherwise, any license or right to use any Trademark displayed herein without the prior consent of the Trademark owner. ARIAL, AUTISM ALLY, AUTISM ALLY design, the CATCH-ALL design, SENIOR TECHNOLOGIES, TABS, TIM, WANDERGUARD, and the WANDERGUARD design are some of the registered and unregistered trademarks owned by The Stanley Works and/or its Affiliates ("Stanley Trademarks"). Stanley Trademarks may not be used in connection with any product or service that is not manufactured by or under license from The Stanley Works or its appropriate Affiliate.

# Table of Contents

Warnings and cautions . . . . .	2
Check your shipment . . . . .	5
How the TABS® monitor works . . . . .	6
Low battery alert . . . . .	6
Installing the wall bracket . . . . .	6
Inserting and removing the monitor . . . . .	8
Deterring removal of the TABS® monitor from the bracket . . . . .	9
Installing the bed bracket . . . . .	10
Wheelchair and door applications . . . . .	10
Inserting the battery . . . . .	10
Alarm options (TABS® Select & TABS® Professional) . . . . .	12
Testing the TABS® mobility monitor . . . . .	17
Using the TABS® mobility monitor . . . . .	18
Maintaining the TABS® mobility monitor. . . . .	19
Troubleshooting the TABS® mobility monitor . . . . .	19
How the TABS® Sidekicks pressure pads work . . . . .	20
Instructions for bed pad use . . . . .	21
Instructions for chair pad use . . . . .	23
Cleaning the pressure pad . . . . .	25
Troubleshooting pressure pads . . . . .	25
Replacement parts and accessories . . . . .	26
Warranty statement . . . . .	27
Daily checklist for TABS® pressure pads . . . . .	28

**▲ WARNING**

Read and follow these Installation instructions, particularly the warnings and cautions, before using your TABS® mobility monitor. Failure to do so may result in injury or death to a person in your care.

Magnets may affect pacemakers and implantable cardioverter defibrillators (ICDs) when placed in close proximity to them. Keep this product, which contains magnets at least 6 inches away from pacemakers and ICDs.

Test your TABS® monitor for proper operation before each use and:

- inspect the cord, clip, disk, bracket and monitor for any signs of damage.
- inspect the Dual Lock® fastener for any signs of wear.
- inspect the disk to be sure it is free from any sticky or oily substances.
- listen to the voice message to make sure it is understandable and appropriate.
- replace any components with signs of wear or damage immediately.

Use your monitor in conjunction with your facility's fall management program. TABS® monitors are not a substitute for proper nursing care. The effectiveness of the TABS® system relies entirely on an immediate response by the caregiver to the TABS® alarm.

Keep the TABS® cord free of all encumbrances at all times. Place the cord on top rather than under pillows. Do not place items on the bed, chair or monitoring location that may interfere with the cord assembly.

Use the proper length of TABS® cord. Using a length outside the caregiver's predetermined safety zone may result in injury to a patient.

Only use a TABS® cord with the TABS® monitor. Any other cord, particularly a cord with higher elasticity, may be unsafe and result in injury to a patient.

The TABS® mobility monitor will not stop a person from leaving a bed, chair, wheelchair or room. It is intended only to alert a caregiver that a person may need assistance. Other interventions may still be required for some people.

The TABS® mobility monitor and TABS® Sidekicks pressure pads can be defeated by a cognitively aware person, a person with only a few moments of lucidity or an uncooperative person. Properly assess each individual before the TABS® mobility monitor is used.

Replace the disk in the disk slot immediately after an alarm and keep the disk in the disk slot at all times to prevent battery drain.

Make sure you have thoroughly read and understand the TABS® mobility monitor instructions before using the pressure pads.

**▲ WARNING**

Visual monitoring by caregivers is required. TABS® Sidekicks pressure pads may not be suitable for all high risk persons; restraints may be required for some people.

A 9V alkaline battery must always be installed for proper operation of the TABS® Professional monitoring system. The battery must be installed for the low battery alert to sound when the battery is low and to act as a battery back-up in the event of power loss on the TABS® Professional.

An intermittent "chirp" indicates a low battery. Replace the battery immediately. Use only 9V alkaline batteries. The TABS® monitor does not recharge batteries.

Keep the pressure pads flat at all times. If the pressure pad is folded it may not function properly. Do not use the pressure pad if it has been folded.

Resident weight may affect proper operation. TABS® pressure pad models 26000, 26100, 26120, 26550, and 26560 are not recommended for persons weighing less than 60 lbs. Models 26500 and 26501 below mattress bed pad are not recommended for persons weighing less than 100 lbs.

Test your pressure pads and TABS® monitor before each use. Make sure your TABS® mobility monitor is working properly. Using the pressure pad for more than 7-days, 90-days or one year (depending on model) is not recommended. If the pressure pads are no longer working discard them immediately.

Make sure the bed pressure pad is attached with the enclosed clips and bands. The pressure pad may not function properly if it is not attached in this manner.

Do not use modular T-connectors with the TABS® Professional (model # 25022). If modular T-connectors are used, the device will not operate properly which could result in injury or death to a person in your care.

Inspect the TABS® monitor to make sure it is held securely to the wall or wheelchair bracket and that the bracket mount is secure. If the mount is not secure, the monitor may be damaged.

Always check to be sure the nurse call interface cord is plugged into the nurse call system before each use of the TABS® monitor. If the cord is unplugged and the monitor's local alarm is off, the monitor will not operate.

Use care when connecting or disconnecting the TABS® monitor to the nurse call system. Gently remove or connect plugs. Pulling on the cord may damage it and result in system failure.

## **▲ WARNING**

Be certain that your protocols direct staff to log the one year, 90-day or 14-day 'Date Put In Use' date in the blank provided on the pad itself AND in the resident's chart. If the pad is used on more than one resident, the original Date Put In Use date must be transferred from chart to chart.

If the cord is unplugged from the monitor and the alarm options have been set to nurse call only, the TABS® monitor reverts to a local alarm. The nurse call interface cord must be plugged into the nurse call system at all times.

Before each use and periodically during the day, check the cord to make sure it is securely in place. Failure to do so may result in injury or death.

## **▲ CAUTION**

Inspect the TABS® monitor to make sure it is held securely to the wall or wheelchair bracket and that the bracket mount is secure. If the mount is not secure, the monitor may be damaged.

Use care when connecting or disconnecting the TABS® monitor to the nurse call system. Gently remove or connect plugs. Pulling on the cord may damage it and result in system failure.

On the TABS® Professional, connect only pressure pads to the jack on the right and connect only nurse call interface cords to the jack on the left on the bottom of the monitor. An alarm will sound if either item is connected to the incorrect jack. Failure to connect a pressure pad or a nurse call cord to the proper jack will cause improper operation of the monitor.

The TABS® Sidekick pressure pads are designed to withstand normal wear and tear for a period of 14-days, 90-days or 1 year (depending on model). Beyond this time, the pad may fail and fail without warning due to prolonged use and other factors, e.g. bending, exposure to moisture, punctures, repeated cord pulls, connector damage, etc.

Do not immerse in liquid, or use the pad if it has been immersed in liquid. Discard the pad if exposed to liquids.

TABS® Sidekicks pressure pads are designed for use with TABS® monitors only. Do not substitute any other fall monitoring devices.

Do not open the TABS® case for any reason, or remove the four screws that hold the case together. The case is sealed and if the seal is broken, the warranty will be voided. Call TABS® Customer Service if your TABS® monitor requires service.

## **▲ CAUTION**

Use only the Dual Lock® fastener or screws that came with your shipment to mount the monitor brackets. Non-conforming fasteners may hinder the device's effectiveness.

Use only the power supply that is shipped with the monitor by Stanley - Senior Technologies. Failure to do so may cause improper operation or damage to the TABS® monitor.

## **Check your shipment**

You should have:

- One TABS® mobility monitor
- One 9V battery

Model #'s 25000, 25011, and 25022 include the following:

- One wall bracket with Dual Lock® fastener
- Standard 30" cord assembly (or length specified at time of ordering)
- Four #4 x 1" long sheet metal screws
- Four #4-8 plastic wall anchors
- One 2" x 2½" piece of Dual Lock® fastener

Model # 25023 includes the following:

- One bed bracket

Model # 25025 includes the following:

- One bed bracket

### **Optional items:**

- Nurse call interface cord
- TABS® pressure pads
- Wheelchair bracket
- TABS® cordless reset
- 12VDC power supply
- Cordless Reset (Key Fob)



**TABS®**  
mobility monitor

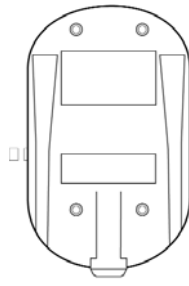

Wall mount bracket

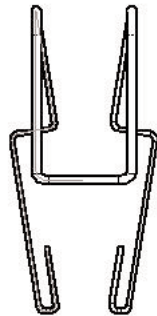

Bed bracket  
(Model 25023 only)

# How the TABS® mobility monitors work

## **▲ WARNING**

Do not install the bracket behind pillows or other objects that may interfere with the movement of the cord. To monitor a person in bed, mount the monitor in the center of the headboard or just above the center of the bed on the wall. Failure to do so may result in injury or death to a person in your care.

Your TABS® monitor is designed to help reduce the risk of falls by alerting caregivers when a resident is leaving a bed, chair, room or wheelchair. Operation is simple. Mount the monitor on a wall using the wall bracket or on a headboard using the bed bracket. Place the disk in the disk slot on the front of the monitor and attach the clip to the resident's garment at the back of the neck. When the resident moves beyond the length of the cord, the caregiver's predetermined safety zone, the disk pulls from the slot and triggers the alarm.

The TABS® Select and Professional monitors have four distinct alarm tones and a nurse call interface which allows a silent local alarm. TABS® Professional also has audio recording capability. Alarm options are determined by the position of rocker switches in the battery compartment. The TABS® Professional is designed for dual monitoring where you can use a pressure pad and a nurse call cord at the same time.

## **Low battery alert**

All TABS® monitors are equipped with a "low battery alert" (an intermittent chirping sound) which reminds you to replace the battery immediately. Listen for the alert each time you use or test your monitor. If you hear the low battery alert, replace the battery immediately. The TABS® Professional must have a functional 9v **alkaline** battery to operate. A plug-in power supply can be used to extend the life of the battery. The low battery alert will sound when a weak 9V battery is installed or when no battery is installed even when the plug-in power supply is used. The TABS® Professional will not function without a functional 9V **alkaline** battery installed.

## **Installing the wall bracket**

TABS® monitors should be mounted on a surface that is smooth and flat. The location should also allow the monitor to be placed on the bracket so that the cord can be pulled from the disk slot easily.



Cordless Reset  
(Optional)

The TABS® wall bracket can be mounted with screws or with Dual Lock® fastener. Choose the method that is appropriate for your particular environment. See "A word about Dual Lock® fastener."

### Mounting the bracket with screws:

You will need:

- level
- drill with  $\frac{3}{16}$ " bit
- hammer
- pencil
- Phillips screwdriver

1. Use the level to position the bracket straight on the mounting surface. Be sure to leave enough room above the bracket for removal of the monitor.
2. Use the bracket as a template and pencil in the screw hole positions.
3. Drill the anchor holes with a  $\frac{3}{16}$ " bit.
4. Hammer in the plastic wall anchors until they are flush with the mounting surface.
5. Align the holes in the bracket to the holes you have drilled and attach the bracket using four of the 4 x 1" screws.

### Mounting the bracket with Dual Lock® fastener

1. Clean the surface with rubbing alcohol and clean rag. Let it dry thoroughly before beginning your installation. Use the level to position the bracket straight on the mounting surface. Be sure to leave enough room above the bracket for removal of the monitor.
2. Peel off the film on the back of the 2½" piece of Dual Lock® fastener. Press the fastener firmly to the wall.
3. Line up the piece of Dual Lock® fastener on the headboard with the two pieces on the bracket (**Figure 1**). Fasten them together by firmly pressing. You will hear a "click" when the Dual Lock® fastener is properly mounted.

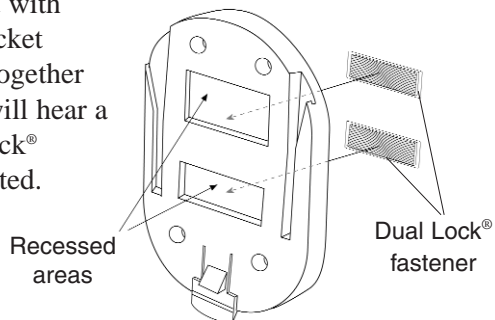

Figure 1

## A word about Dual Lock® fastener

According to the manufacturer, if Dual Lock® fastener is used properly it can withstand up to 1,000 closures before replacement is necessary. Inspect each piece of Dual Lock® fastener regularly and replace each piece at the first sign of wear.

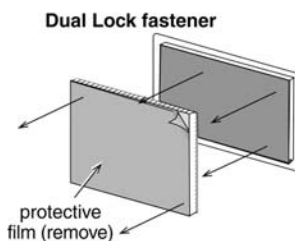

Figure 2

A piece of film covers the adhesive on the back of each piece of Dual Lock® fastener (**Figures 2 and 3**). The adhesive is very strong – it was manufactured for one mount only so never reuse a piece of Dual Lock® fastener. If you remove a piece of Dual Lock® fastener from the mounting surface or bracket, replace it with a new piece of Dual Lock® fastener.

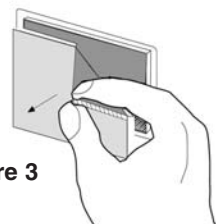

Figure 3

### To remove Dual Lock® fastener:

The adhesive on Dual Lock® fastener bonds well enough to the mounting surface that there is a possibility it may damage your wall when you remove it. Gently grab a corner of the fastener and ease your fingers under it. Roll the Dual Lock® fastener slowly off the mounting surface.

## Inserting and removing the monitor

After the bracket has been mounted and your alarm options have been set, insert your TABS® monitor into the bracket.

1. Slide the monitor into the bracket. You will hear a "click" when it is properly locked into place. The front of the bracket should face the resident.
2. Check to make sure the monitor is securely in place by pulling it gently upward.

### To remove the monitor

1. Gently press the release lever on the bottom of the wall bracket with one hand toward the mounting surface.
2. While pushing the release lever with one hand, slide the monitor up out of the wall bracket.

## Deterring removal of the TABS® monitor from the bracket

### **▲WARNING**

The monitor must be properly placed in the bracket. Check to make sure it is locked into position before each use. Failure to do so may result in injury or death to a person in your care.

In the event the TABS® monitor is removed from the slide lock bracket or tampered with by residents or other non-authorized people, you may wish to make it more difficult to remove the TABS® monitor from the bracket. This can be accomplished by breaking off the lower portion of the release tab. Once the release tab has been removed, a pen or similarly shaped object carried by staff will need to be inserted into the release catch before you can slide the TABS® monitor out of the bracket.

1. If the bracket has already been installed, remove it from the wall.
2. Firmly hold the upper portion of the release tab with one hand.
3. The release tab is scored with a mark (**Figure 4**). Carefully position pliers along the lower side of the score mark.
4. Bend the tab backward until it breaks off (**Figure 5**).

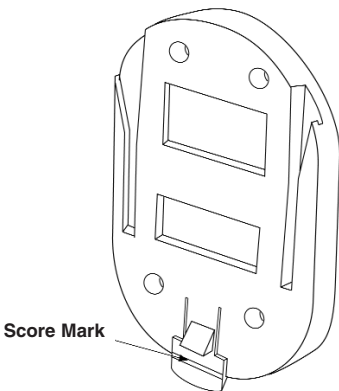

**Figure 4**

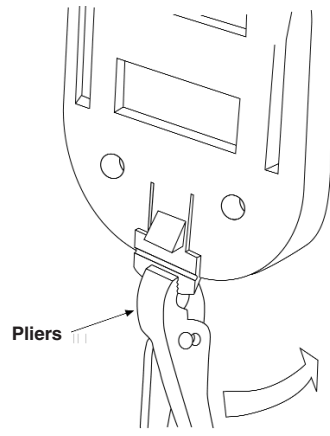

**Figure 5**

## Installing the wire bracket (included with Model 25023)

To attach the bracket to the TABS® monitor, slide the bracket onto the back of the monitor as shown in Figure 6.

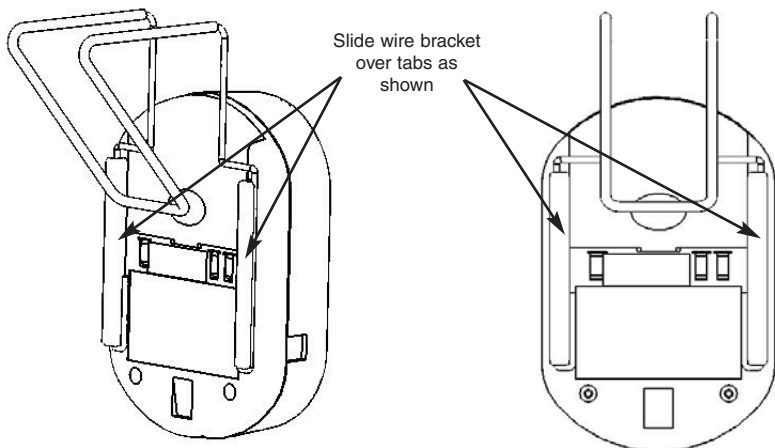

Figure 6

## Wheelchair and door applications

Your TABS® mobility monitor can also be used to monitor a person in a wheelchair or to monitor an interior door. Contact your TABS® Representative to obtain the Wheelchair Bracket Assembly (Model 25100) or Easy-Clip Wheel Chair Bracket (Model 25300) or the Door Mount Kit (Model 24010).

## Inserting the battery

### **▲WARNING**

Do not pull on the battery snap wires when installing and removing batteries. Use care when removing and installing your battery to prevent any damage to the system that may result in injury or death to the person in your care.

**USE 9V ALKALINE BATTERIES ONLY** when replacing batteries. Failure to do so may affect the operation of the low battery alert, which could result in injury or death to a person in your care.

**DO NOT USE RECHARGEABLE BATTERIES. THE TABS® PROFESSIONAL DOES NOT RECHARGE BATTERIES.**

Your TABS® monitor is shipped without the battery in place.

**To insert the battery:**

1. Place the disk in the disk slot.
2. Remove the battery cover (**Figure 7**).
3. Lift the battery snap gently as you attach the battery to the snap.  
**Do not pull on the wires.**
4. The battery compartment was designed to hold the battery snugly in place. Replace the battery so that the battery snap wires are out of sight on the bottom of the compartment.
5. Replace the battery cover.
6. Test the monitor by removing the disk from the slot. The alarm will sound. See the "Troubleshooting" section if your alarm fails to sound.

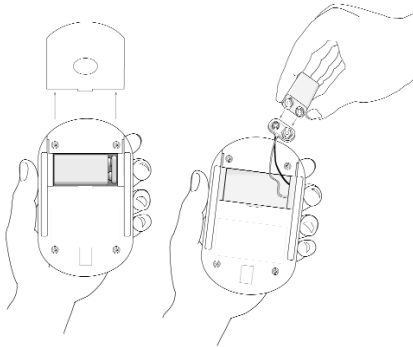

**Figure 7**



**Figure 8**

**Connecting optional plug-in power supply for the TABS® Professional**

On the TABS® Professional there is a red indicator light on the front of the monitor indicating power is being supplied by the plug-in power supply (**Figure 8**). A 9V alkaline battery needs to be installed at all times even while using the plug-in power supply. This will provide a back-up if AC power is interrupted. A low battery indicator will alarm if the battery power falls below safety requirements.

Insert plug-in power supply into power supply jack on left side of monitor (**Figure 8**). The red indicator light on the front of the case will be on when the monitor is connected to the plug-in power supply.

Use only the power supply that is shipped with the monitor by Senior Technologies. Failure to do so may cause improper operation or damage to the TABS® monitor.

# Alarm options for TABS® Select & TABS® Professional models

All options are set by adjusting a row of four rocker switches under the battery cover (**Figure 9**). To set options, remove the battery cover. Follow the diagrams below (**Figure 10**) for each option you select. When your options are set, replace the battery cover and test the monitor.

The position of the number 1 and number 2 switches determines the tone. The number 3 switch turns the local alarm on and off (only available when using nurse call interface). The number 4 switch is for voice mode.

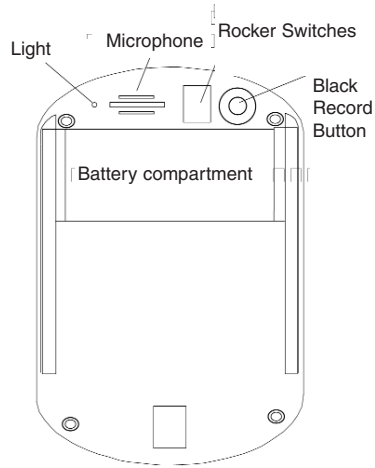

**Figure 9**

Use a ballpoint pen to move the switches.

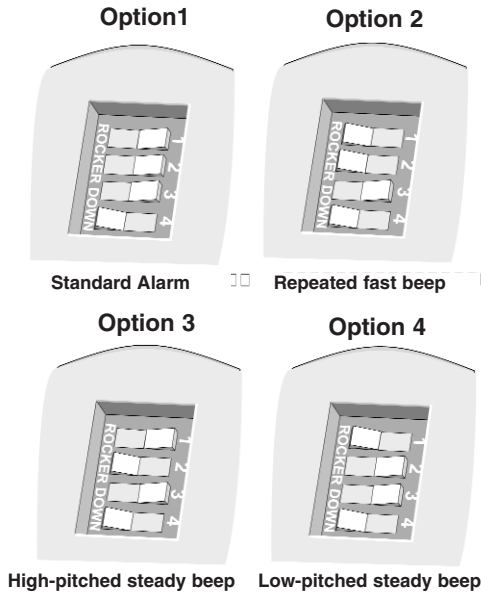

**Figure 10**

# Local alarm on/off

## **▲ WARNING**

If the nurse call interface cord is unplugged from the monitor and the alarm options have been set to nurse call only, the TABS® monitor reverts to a local alarm. The nurse call interface cord must be plugged into the nurse call system at all times.

Before each use and periodically during the day, check the cord to make sure it is securely in place. Failure to do so may result in injury or death to a person in your care.

If you are using the nurse call interface cord, you can set your TABS® monitor for a local alarm and nurse call alarm (**Figure 11, Option a**) or nurse call alarm only (**Figure 11, Option b**). The nurse call interface cord must be in place in the TABS® monitor to make these selections.

If the cord is detached from the monitor, the monitor will automatically revert to the local alarm mode. To set the nurse call only, move the number 3 rocker switch to the right position.

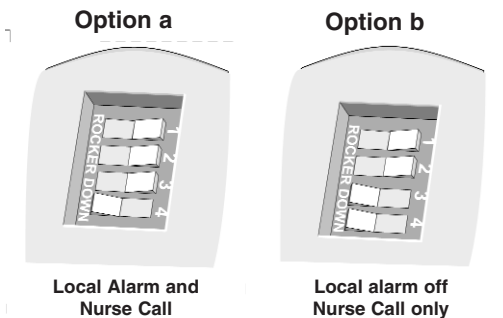

**Figure 11**

# Nurse call interface

## **▲WARNING**

Do not pull on the cord to remove the nurse call interface cord from either the TABS® monitor or the nurse call interface wall jack. Remove them by grasping the modular telephone plug and the jack plug heads and pulling them carefully from the wall. Failure to do so may result in damage to the equipment.

## **TABS® Professional**

Attach the end of the cable with the modular telephone plug to the jack on the left of the TABS® Professional monitor (**Figure 12**). Insert the other end of the cable with the ¼" jack plug into the nurse call system wall jack. If the plug does not fit the wall jack, call TABS® Customer Service at 800-824-2996.

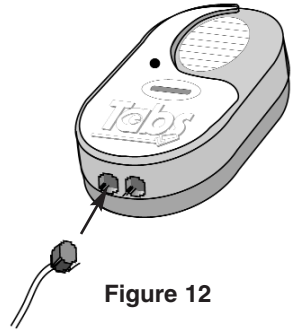

**Figure 12**

***Note:** If the nurse call interface cord is not in place, the local alarm will sound regardless of the settings. If a nurse call interface cord is mistakenly inserted in the jack on the right an alarm will sound.*

Regulations may require that a functioning nurse call system be accessible in each resident bed and bath area. A splitter may be required from your nurse call provider in order to use both TABS® and your regular call system. Please contact TABS® Customer Service at 800-824-2996 if you need assistance.

## TABS® Select monitor (Optional T-connector)

### **WARNING**

Use only the modular T-connector provided by the manufacturer. If other modular T-connectors are used the device may not operate properly which could result in injury or death to a person in your care.

Do not connect two pressure pads to the T-connector. The TABS® monitoring system will not operate properly which could result in injury or death to a person in your care.

Test your TABS® monitoring system before each use. Failure to do so could result in injury or death to a person in your care.

The modular T-connector lets you connect the TABS® chair or bed pad to the TABS® monitor and your nurse call system. **Do not connect two pads to the T-connector.**

1. Remove any cords that may be attached to the bottom of the TABS® Select or Voice+ monitor.
2. Plug the modular T-connector into the bottom of the TABS® Select or Voice+ monitor.
3. Plug the nurse call cable and the TABS® Sidekicks cable into either of the two connections on the modular T-connector.
4. Follow the instructions in "Testing the system". The alarm should appear on your nurse call system console. If it does not, check your connections and test again. If it still does not work, call TABS® Customer Service at 800-824-2996.

***Note:*** *If the nurse call interface cord is not in place, the local alarm will sound regardless of the settings.*

## Voice alarm (TABS® Professional)

Your TABS® Professional monitor (**Figure 13**) has audio recording capability. You can record a message up to 10 seconds in length.

To record a voice message:

1. Remove the battery cover.
2. Push down the black record button and hold it down until you are finished recording. The light will be on during this time indicating the monitor is recording (**Figure 13**).
3. Hold the monitor 8" - 12" from your mouth and record your message. Speak slowly and enunciate your words.
4. Replace the battery cover.
5. When finished recording, review your message by pulling the disk from the disk slot. Your message should be easily understood and heard. If it is not, re-record by following Steps 1 through 3.

Note: By rapidly removing and re-applying pressure to chair or bed pads while connected to the TABS® mobility monitors 25000 series may cause the monitor to bypass the voice alert and go directly to sounding the audible alarm.

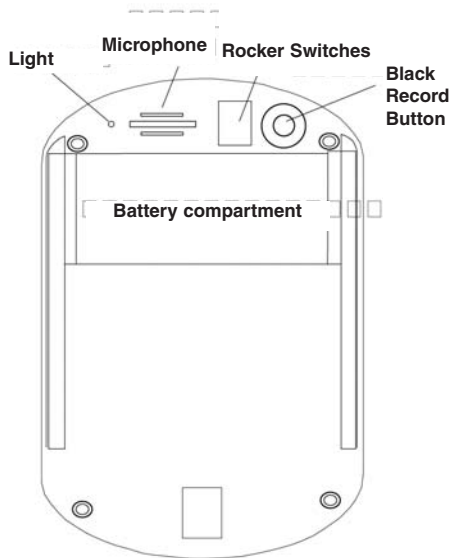

**Figure 13**

## Voice options (Figure 14)

- To silence the local alarm without voice message, push switches 3 & 4 to the right. The nurse call cord **must be** connected (**Option a**).
- For local alarm without voice message, push switch 3 to the left and switch 4 to the right (**Option b**).
- For local alarm with voice message, move both switches 3 and 4 to the left (**Option c**).
- If you want the voice message to repeat itself, move the number 3 rocker switch to the right and the number 4 rocker switch to the left (**Option d**). The nurse call cord must be connected for the message to repeat.

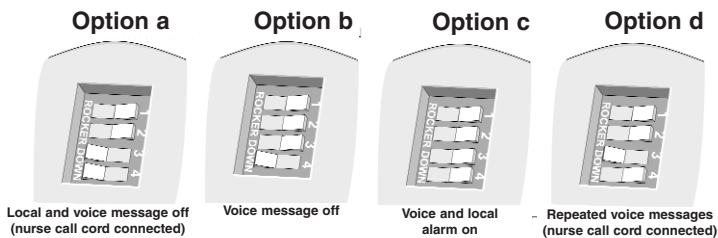

Figure 14

### **⚠ WARNING**

## Testing the TABS® mobility monitor

Test your TABS® mobility monitor before each use to ensure that it is working properly. Failure to do so may result in injury to a person in your care.

Before each use, test your TABS® mobility monitor.

1. Remove the disk from the disk slot. Listen for the alarm to sound.
2. Reinsert the disk into the disk slot, and the alarm should stop. If you hear the low battery alert (a low chirping sound) replace the battery immediately.

# Using the TABS<sup>®</sup> mobility monitor

## **▲ WARNING**

**Magnets may affect pacemakers and implantable cardioverter defibrillators (ICDs) when placed in close proximity to them. Keep this product, which contains magnets at least 6 inches away from pacemakers and ICDs.**

You determine the "safety zone" – how far you want the person in your care to move before triggering the alarm – by varying the length of the cord. When selecting cord length keep in mind:

- The cord must be long enough to allow the person in your care to move within your safety zone without triggering the alarm
- The cord must be short enough to trigger the alarm when the person in your care moves out of your safety zone.

Standard cord length is 30 inches for monitoring people in bed and 18 inches for monitoring people in wheelchairs, but other cord lengths are available: 18", 24", 30", 36", 42" or custom length. Call your TABS<sup>®</sup> Representative to order additional cord lengths.

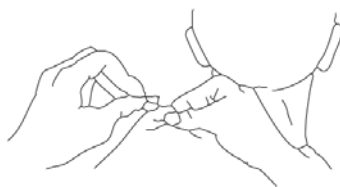

**Figure 15**

Remember to only use a TABS<sup>®</sup> cord. They're designed specifically for the TABS<sup>®</sup> mobility monitoring system. If you use a different cord, it will not only void your warranty, but more importantly, the person in your care may be injured.

## **Attaching the clip**

Attach the clip to the person's garment at the top of the shoulder or close to the back of the neck. Make sure the clip does not catch the person's skin. The clip attaches to most materials securely and without damage; some fragile or slick materials may prevent proper attachment or may be damaged by the clip. The clip has a locking tab which must be folded down to open the clip. When the clip is attached, the tab should be flipped up to prevent easy detachment by the patient. (See diagrams below)

**Locking  
Tab**

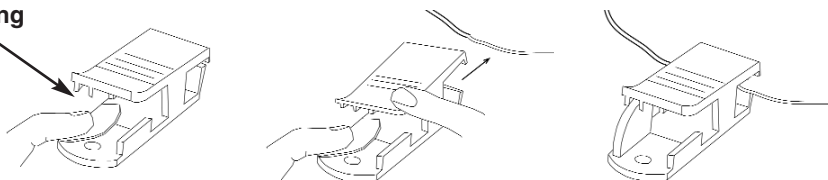

Check the garment clip regularly to make sure it is attached correctly and is not damaged. A damaged clip may have sharp edges that may injure the person in your care.

## Maintaining the TABS® mobility monitor

- Clean soiled areas on the monitor, disk, clip, cord and bracket with a damp rag and mild detergent. Dry the clip and disk to prevent corrosion.
- The Dual Lock® fastener may be cleaned with most standard medical virucidal disinfectant. Spray the disinfectant on the Dual Lock® fastener and allow it to dry thoroughly. If necessary, a toothbrush may be used to gently scrub the "mushrooms."
- Inspect your TABS® monitor and all components including cord, clip, disk, Dual Lock® fastener and the wall bracket regularly. If there are any signs of wear or damage, replace the component immediately. Call your TABS® Representative if you do not already have replacement parts on hand.
- Replace the battery as soon as the low battery alert sounds.
- Inspect Dual Lock® fastener regularly. Replace it at the first signs of wear or damage.

## Troubleshooting the TABS® mobility monitor

*If the alarm system is not triggered when the disk is pulled from the slot on the monitor:*

- Check the battery. Is it installed properly? Does it need to be replaced?

*If the alarm delays in triggering or the system is false-alarming:*

- Check the cord. Is it the right length for the application and for that particular resident?
- Check the bracket. Is it installed on a smooth, flat surface?
- Check the monitor. Is it facing the resident?
- Check the monitor. Is it "locked" into the bracket?
- Check the monitor. Is it used on an uncooperative resident? The TABS® mobility monitoring system can be defeated by a cognitively aware person, a person with only a few moments of lucidity or an uncooperative person.

*If the alarm system is not triggered when pressure is removed from the pressure pad:*

- Check to make sure two pressure pads are not connected to the monitor.

If the pressure pads still do not work, call TABS® Customer Service at 800-824-2996.

## How the TABS® Sidekicks pressure pads work

### **WARNING**

The TABS® Sidekick pressure pads were designed to withstand normal wear and tear for a period of 14-days, 90-days or 1-year (depending on model.) Do not use beyond this period. Beyond this period, the pad may fail and fail without warning due to prolonged use and other factors, e.g. bending, exposure to moisture, punctures, repeated cord pulls, connector damage, etc.

**Be certain that your protocols direct staff to log the DATE PUT IN USE in the blank provided on the pad itself AND in the resident's chart. If the pad is used on more than one resident, the original removal date must be transferred from chart to chart.**

**Resident weight may affect proper operation. TABS® pressure pad models 26000, 26100, 26120, 26550, and 26560 are not recommended for persons weighing less than 60 lbs. Models 26500 and 26501 below mattress bed pad are not recommended for persons weighing less than 100 lbs.**

The TABS® monitoring system is designed to alert caregivers when someone is leaving a bed, chair or wheelchair. TABS® Sidekick pressure pads can be used alone or with an optional cordless reset in conjunction with the TABS® cord disk assembly.

The TABS® Sidekick pressure pad is placed on a bed, chair or wheelchair according to the instructions included with the pad. The cord is connected to either the TABS® Select or Professional monitor. See "Alarm Options" in this manual to set the desired alarm option. The disk is inserted into the TABS® disk slot.

TABS® Sidekicks pressure pads are designed for use with TABS® monitors only. Do not substitute any other fall monitoring devices. TABS® Sidekick pressure pads are the only pressure pads that can be used with the TABS® monitor.

The TABS® Select and TABS® Professional alarm is "non-latching." The alarm will stop if the resident returns to the bed or chair. If used in conjunction with the TABS® cord disk assembly, the alarm sounds when the disk is pulled from the disk slot or when pressure is removed from the pressure pad, whichever comes first. The alarm is quickly and easily reset by reinserting the disk in the disk slot or reapplying pressure to the pressure pad.

For the TABS® Select with an optional T-connector a pressure pad can be used along with a nurse call interface cord.

The TABS® Professional has a built-in jack so that a pressure pad can be used along with a nurse call interface cord.

# Instructions for bed pressure pad use

1. Place the pressure pad across the width of the mattress.
2. Position the pressure pads so that the resident's buttocks will be over the top of the pad.

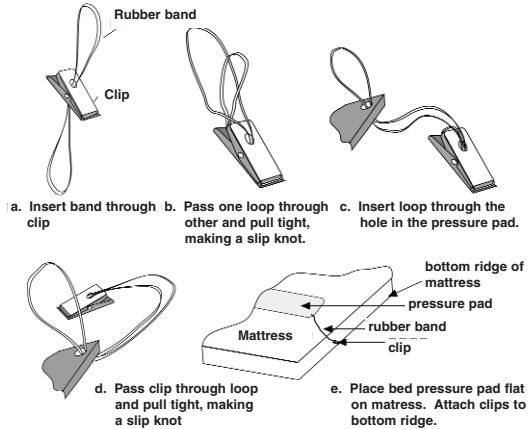

Figure 16

4. Put the bed sheets over the top of the bed pad. **Note:** Use of a mattress overlay or bed pad may affect the proper operation of the bed pressure pad. Follow test procedure.

## 5. TABS® Select

Make sure that the disk or optional cordless reset is in the TABS® monitor disk slot. Plug the bed pressure pad cord into the connector on the bottom of the TABS® monitor (Figure 17).

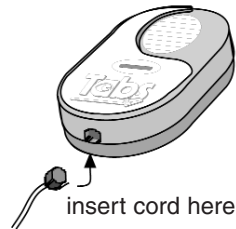

Figure 17

## TABS® Professional

Make sure that the disk or optional cordless reset is in the monitor's disk slot. Plug the bed pressure pad cord into the right jack on the bottom of the TABS® monitor (Figure 18). An alarm will sound if a pad is plugged into the nurse call (left) jack and weight is applied to the pad.

**Note:** For the timed bed pad model 26560, the timer will begin counting down when plugged into a monitor for the first time. The timer will only activate when used with models 25022, 25023, 25025, 25222, or 25223

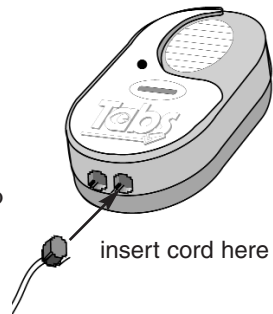
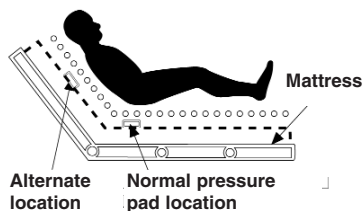

Figure 18

6. Mount the TABS® mobility monitor on the headboard or wall. Refer to "Installing your TABS® monitoring system" in this manual for more detailed information on mounting the monitor.

7. The monitor will “chirp” when weight is first applied to the pad to indicate the monitor is armed. Test the system by pressing firmly on the pressure pad for 3 seconds. When you remove the pressure, the alarm must sound. Reset the alarm.
8. Have the resident lie normally on the mattress. The resident’s body weight activates the system.
9. The alarm must sound when the resident’s body weight is removed from the pressure pad.



**Figure 19**

## Testing the system

Test the TABS® monitoring system before each use and inspect the pressure pads and TABS® monitor regularly to make sure they are not damaged. Test the pressure pads by pressing firmly on the pressure pad for 3 seconds. When you remove the pressure, the alarm will sound. Reset the alarm.

## To reset the alarm

1. If you are using only the pressure pad, reset the alarm by removing the disk or optional cordless reset (Key Fob) and reinsert in the disk slot or by replacing weight on the pressure pad.
2. If you are using both the pressure pad and the TABS® cord disk assembly and the disk is pulled from the disk slot, reset the alarm by reinserting the disk into the disk slot.

# Instructions for chair pressure pad use

1. Place the pressure pad in the center of the chair seat. The side of the pressure pad with the cord on it should be at the back of the chair seat (**Figure 20**). Do not place the cord on top of or underneath the pressure pad.
2. Place the disk or optional cordless reset in the disk slot.
3. **TABS® Select**

Plug the TABS® Sidekick pressure pad cord into the connector on the bottom of the TABS® monitor (**Figure 21**).

### TABS® Professional

Plug the TABS® Sidekick pressure pad cord into the right jack on the bottom of the TABS® monitor (**Figure 22**). An alarm will sound if a pad is plugged into the nurse call (left) jack and weight is applied to the pad.

**Note:** For the timed chair pad model 26120, the timer will begin counting down when plugged into the monitor for the first time. The timer will only activate when used with models 25022, 25023, 25025, 25222, or 25223.

4. Mount the TABS® monitor on the wheelchair bracket (Model 25100 or 25300). For proper mounting instructions, refer to "*Mounting the bracket*" section.
5. The monitor will "chirp" when weight is first applied to the pad to indicate the monitor is armed. Test the system by pressing firmly on the pressure pad for 3 seconds. When you remove the pressure, the alarm will sound. Reset the alarm.
6. Place the resident on the pressure pad. The pressure pad should be centered under the resident's body.
7. When the resident leaves the pressure pad, the alarm will sound.

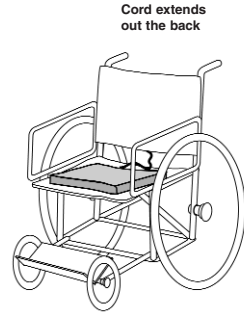

**Figure 20**



**Figure 21**

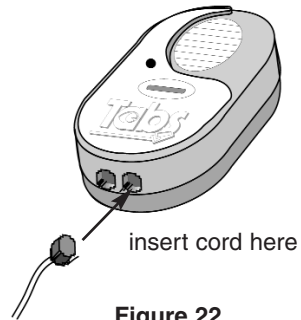

**Figure 22**

## **Testing the system**

Test the TABS® monitoring system before each use and inspect the pressure pads and TABS® monitor regularly to make sure they are not damaged. Test the pressure pads by pressing firmly on the pressure pad for 3 seconds. When you remove the pressure, the alarm will sound. Reset the alarm.

## **To reset the alarm**

1. If you are using only the pressure pad, reset the alarm by removing the disk or cordless reset (Key Fob) and reinsert in the disk slot or by replacing weight on the pressure pad.
2. If you are using both the pressure pad and the TABS® cord disk assembly and the disk is pulled from the disk slot, reset the alarm by reinserting the disk into the disk slot.

## **Cleaning the pressure pad**

- Clean soiled areas of cord and pressure pad with a clean cloth and water or a vinyl-tolerant solution.
- **Do not immerse pressure pad in liquid of any kind.**

## **Troubleshooting pressure pads**

*If the alarm does not sound when the resident leaves the chair or bed:*

- Check the TABS® monitor. Are you using a 9V alkaline battery and has it been installed properly? If not, remove the battery and install a 9V alkaline battery following the instructions in this manual.
- Check the cord. Is it connected to the TABS® monitor and is the connection secure? If not, connect the cord properly.
- Is the resident under 60 pounds (for pad Model's 26000, 26100, 26120, 26550, and 26560) or under 100 pounds if using pad Model's 26500 or 26501 and are you using only the pressure pad? If so, switch to monitoring the resident with the TABS® cord disk assembly only.
- Is the resident sitting properly on the pressure pad? If not, reposition the pressure pad so that it is centered under the resident's body.
- If using a TABS® Professional monitor, is the pressure pad connected to the jack on the right side of the monitor. If not, reconnect the pad jack to the proper jack on the monitor.

*If the alarm sounds when the resident has not left the bed or chair:*

- Check to see that a fresh 9V alkaline battery is being used. If not, replace it.
- Check to see that the pressure pad cord is attached to the TABS® monitor.
- Check to see that the pressure pad is positioned correctly under the patient.

*If the alarm sounds periodically:*

- Check to see if the disk or cordless reset (Key Fob) has been removed from the monitor. If so, replace it.
- Check the battery. The sound you hear may be the low battery alert. Replace the battery with a 9V alkaline battery following the instructions in the "Insert the battery" section.

If the pressure pads still do not work, call TABS® Customer Service at 800-824-2996.

**Replacement parts and accessories****Model/Part #**

TABS® Professional monitor (with wall bracket)	25022
TABS® Professional monitor (with wire bracket)	25023
TABS® Select monitor	25011
TABS® Basic monitor	25000
TABS® Voice+ monitor (with wall bracket)	25222
TABS® Voice+ monitor (with wire bracket)	25223
TABS® Elite Silver monitor	29800
Wheelchair bracket assembly and bungee cords	25100
Easy-Clip Wheelchair bracket	25300
Wall mount bracket	25120
Wire mount bracket	0120-123
Nurse call interface cord	25150
Nurse call splitter	0707-421
Door mount kit	24010
Chair pressure pad (90-day)	26000
Bed pressure pad (90-day)	26100
Timed chair pressure pad (90-day)	26120
P.S.D. chair pressure pad (14-day)	26200
P.S.D. bed pressure pad (14-day)	26300
Bed pressure pad (below mattress))	26500
Bed pressure pad (above mattress)	26550
Timed bed pressure pad (1-yr)	26560
15" cord (white)	24040
18" cord (fluorescent green)	24050
24" cord (green)	24060
30" cord (fluorescent orange)	24070
36" cord (yellow)	24080
42" cord (fluorescent pink)	24090
Dual Lock® fastener (2" x 2½")	24130
Dual Lock® fastener (2" x 1")	24131
Dual Lock® fastener 1 each: (2½" x 1" and 2" x 2½")	24132
Dual Lock® fastener (2" x ¾")	24135
Cordless reset (Key Fob)	0707-280
12VDC plug-in power supply (U.S.)	0400-026
12VDC plug-in power supply (U.K.)	0400-066
Modular T-connector	0707-322

## **TABS® Warranty:**

**LIMITED LIFETIME WARRANTY.** TABS® products are warranted to be free of defects in materials and workmanship by Stanley Security Solutions, Inc., Senior Technologies Division, (seller, hereinafter called "ST"). If any defects covered by this Warranty appear, ST will, at its option, repair or replace the defective component on an exchange basis with new or rebuilt parts at its expense, without charge for parts or labor upon delivery of such product to ST at Buyer's expense. **EXCEPTION: TABS® PADS AND ACCESSORY PRODUCTS ARE WARRANTED TO BE FREE OF MANUFACTURING DEFECTS FOR PERIODS RANGING FROM 90 DAYS TO ONE-YEAR AS SPECIFIED TO CUSTOMER.** ST is not responsible for warranty service should the TABS® product fail to be properly maintained or fail to function properly as a result of misuse, abuse, neglect, or damage caused by disasters, such as fire or lightning, damage caused by water-immersion, faulty or leaking batteries not supplied by ST, service other than by ST or units in use in violation of instructions furnished by ST. Postage, insurance, or shipping costs incurred in presenting your TABS® product for warranty service are your responsibility.

**THE FOREGOING WARRANTIES ARE EXCLUSIVE AND IN SUBSTITUTION FOR, AND IN SUBMISSION FOR AND BUYER HEREBY WAIVES, RELEASES AND RENOUNCES, ALL OTHER WARRANTIES, OBLIGATIONS AND LIABILITIES OF ST AND ALL OTHER RIGHTS, CLAIMS AND REMEDIES OF BUYER AGAINST ST, EXPRESS OR IMPLIED, ARISING BY LAW OR OTHERWISE, WITH RESPECT TO ANY NONCONFORMANCE OR DEFECT IN ITEMS OR SERVICES PURCHASED HEREUNDER, INCLUDING, BUT NOT LIMITED TO: (A) ANY IMPLIED WARRANTY OF MERCHANTABILITY OR FITNESS FOR A PARTICULAR PURPOSE; (B) ANY IMPLIED WARRANTY ARISING FROM COURSE OF PERFORMANCE, COURSE OF DEALING OR USAGE OF TRADE; (C) ANY OBLIGATION, LIABILITY, RIGHT, CLAIM OR REMEDY IN TORT, WHETHER OR NOT ARISING OUT OF THE NEGLIGENCE OF SENIOR TECHNOLOGIES (WHETHER ACTIVE, PASSIVE OR IMPUTED); AND (D) ANY OBLIGATION, LIABILITY, RIGHT, CLAIM OR REMEDY FOR LOSS OF, OR DAMAGE TO, ANY EQUIPMENT.**

**ST SHALL HAVE NO OBLIGATION OR LIABILITY, WHETHER ARISING IN CONTRACT, TORT OR OTHERWISE, FOR LOSS OF USE, REVENUE OR PROFIT, COST OF CAPITAL, COST OF SUBSTITUTE EQUIPMENT, ADDITIONAL COSTS INCURRED BY BUYER, BUYER'S CUSTOMERS OR OTHER THIRD-PARTIES, FOR DAMAGES RESULTING FROM PERSONAL INJURY OR PROPERTY DAMAGE OR ANY OTHER INCIDENTAL OR CONSEQUENTIAL DAMAGES WITH RESPECT TO ANY NONCONFORMANCE OR DEFECT IN ANY ITEMS PROVIDED HEREUNDER.**

